

**Typ: RDS17-48**  
 58-61mm Türblatt  
 (Zusatzfalz = 20mm)

Kantenriegel:  
 Wange 44mm/Falz 50mm

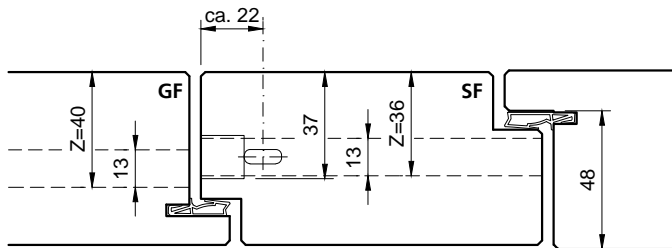

Gehflügel

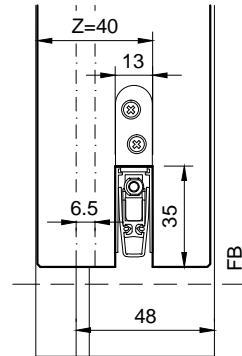

Stehflügel

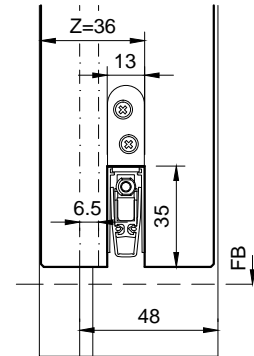

Hebelkantenriegel:  
 Wange 44mm/Falz 50mm

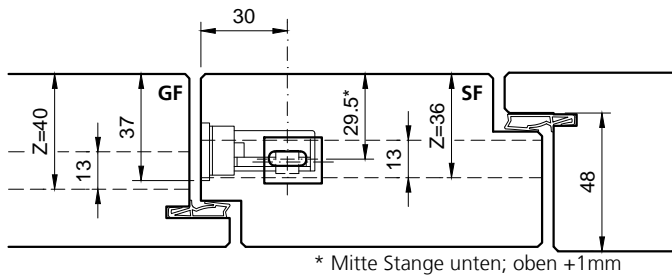

Gehflügel

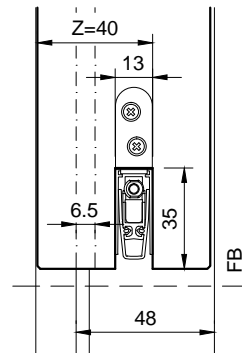

Stehflügel

