

**Standard**

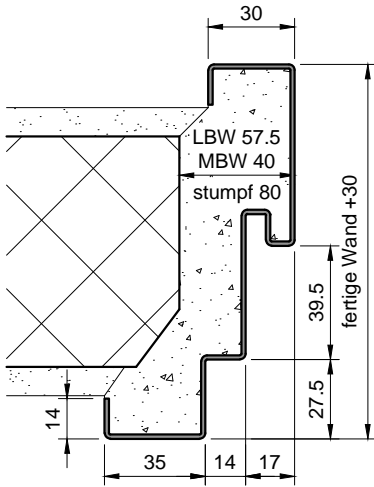

**Steckzarge**

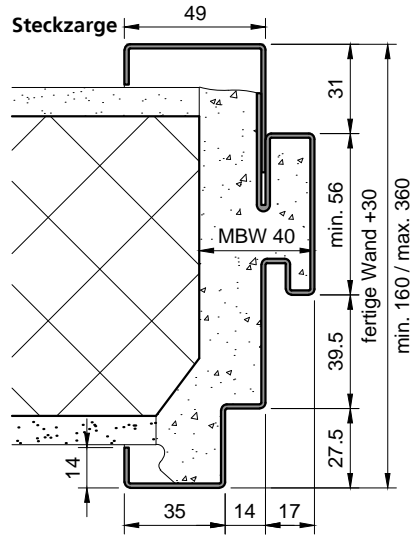

**Ausführung: W**  
(verbreiteter Spiegel)

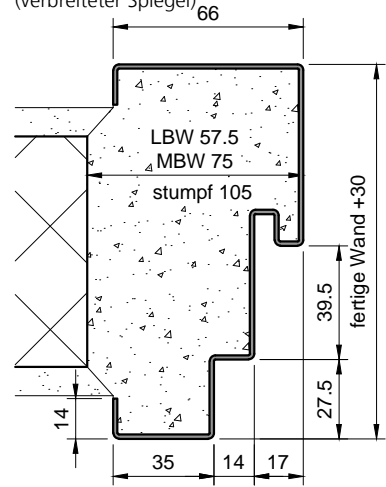

**Ausführung: N**  
(Schatten-Nut)

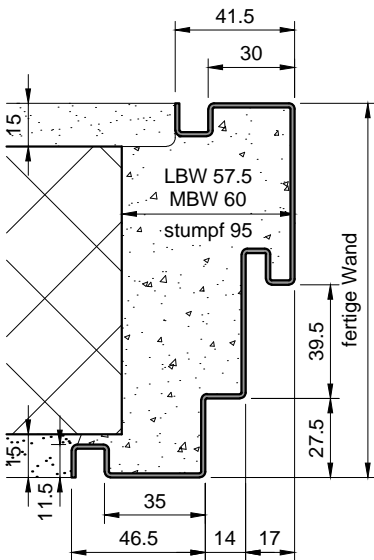

**Ausführung: N-W**  
(verbreiteter Spiegel und Schatten-Nut)

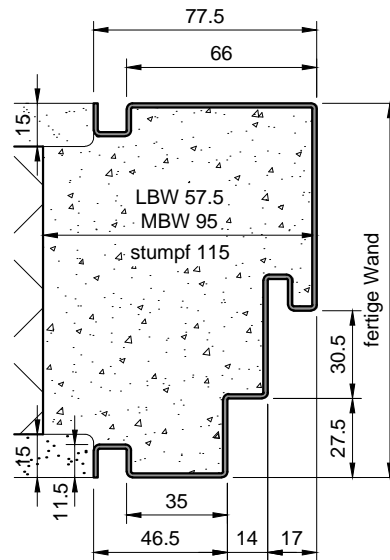

**Ausführung: OS**  
(ohne Spiegel)

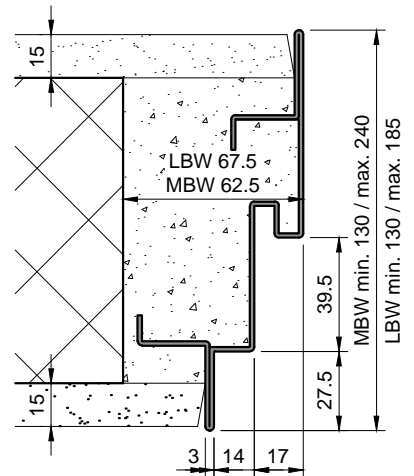

**Schema:**  
mit stumpfem Maueranschlag

